

POP UP DISPLAY USER MANUAL



PIXLIP[®] POP

TIPS

 **VIDEO MANUAL**

<https://www.pixlip.com/manuals/#127000>



**ASSEMBLY ONLY
WITH CLEAN
HANDS**



**ONLY TO BE MOUNTED
ON A CLEAN AND SOFT
SURFACE**

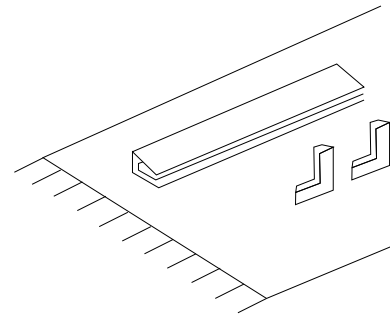
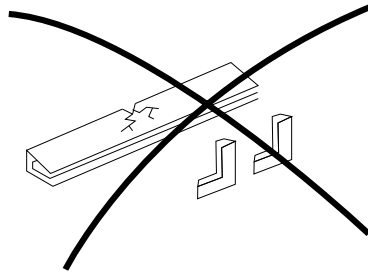

**ONLY CONNECT TO A
NEARBY SOCKET. DO NOT
USE EXTENSION CABLES.**

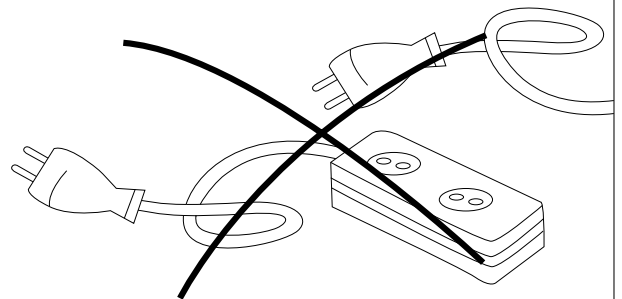
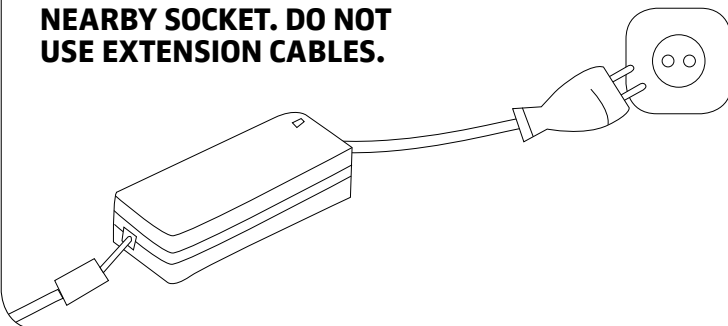

COMPONENTS

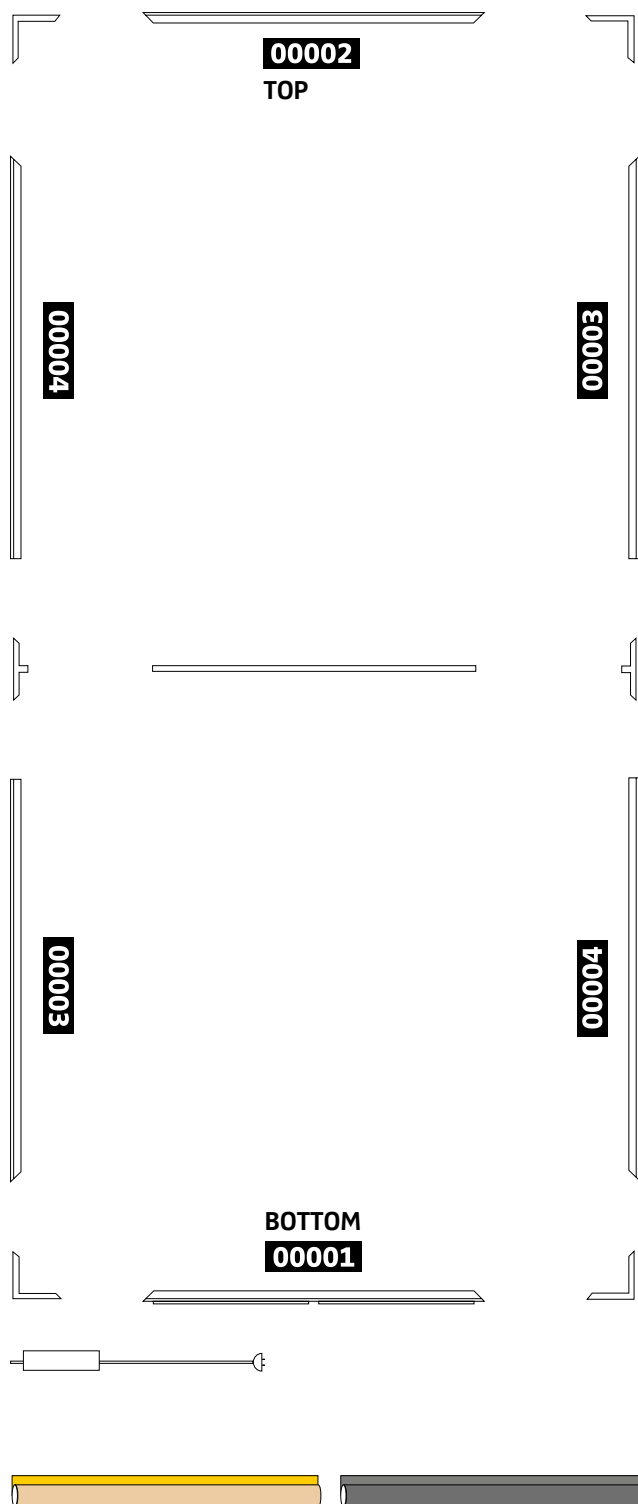

00001 BOTTOM

1 × Base profile with foot plates

00002 TOP

1 × Top profile

00003

2 × Side profile

00004

2 × Side profile

4 × Corner connector

1 × Strut

2 × Strut holder

1 × Power supply

1 × Print textile

1 × Blockout with LED stripes

1

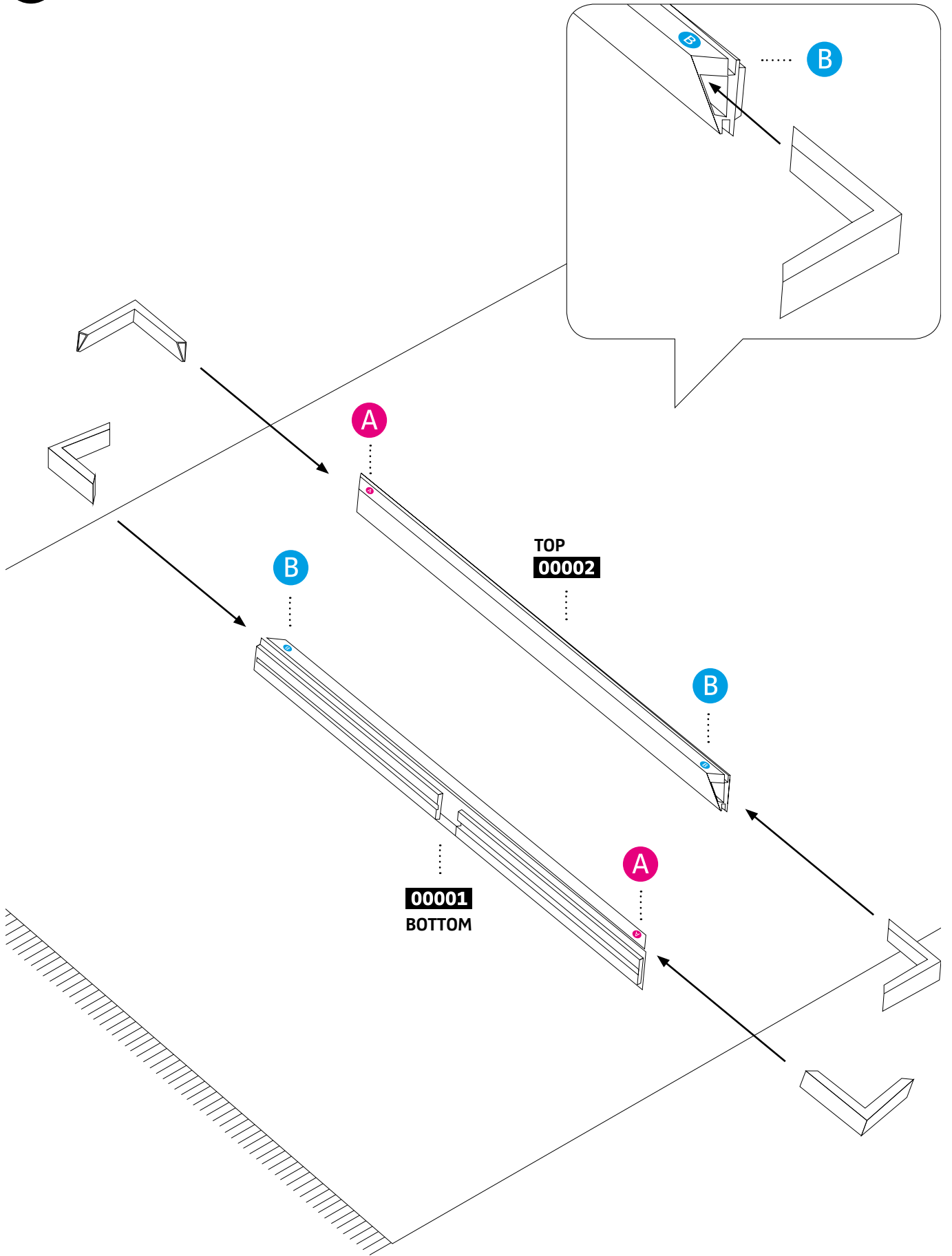

2

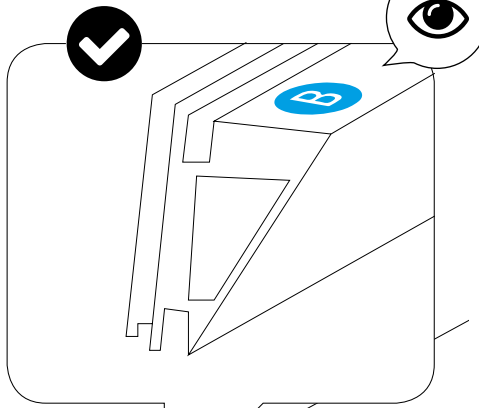
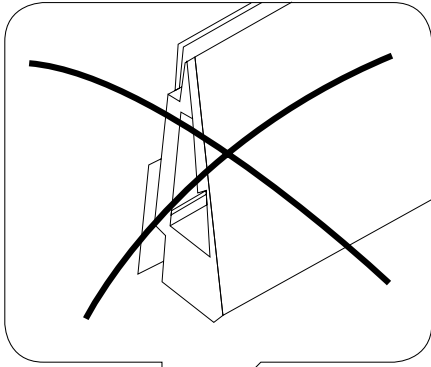

For correct installation, the coloured stickers must point upwards and be visible at all times.

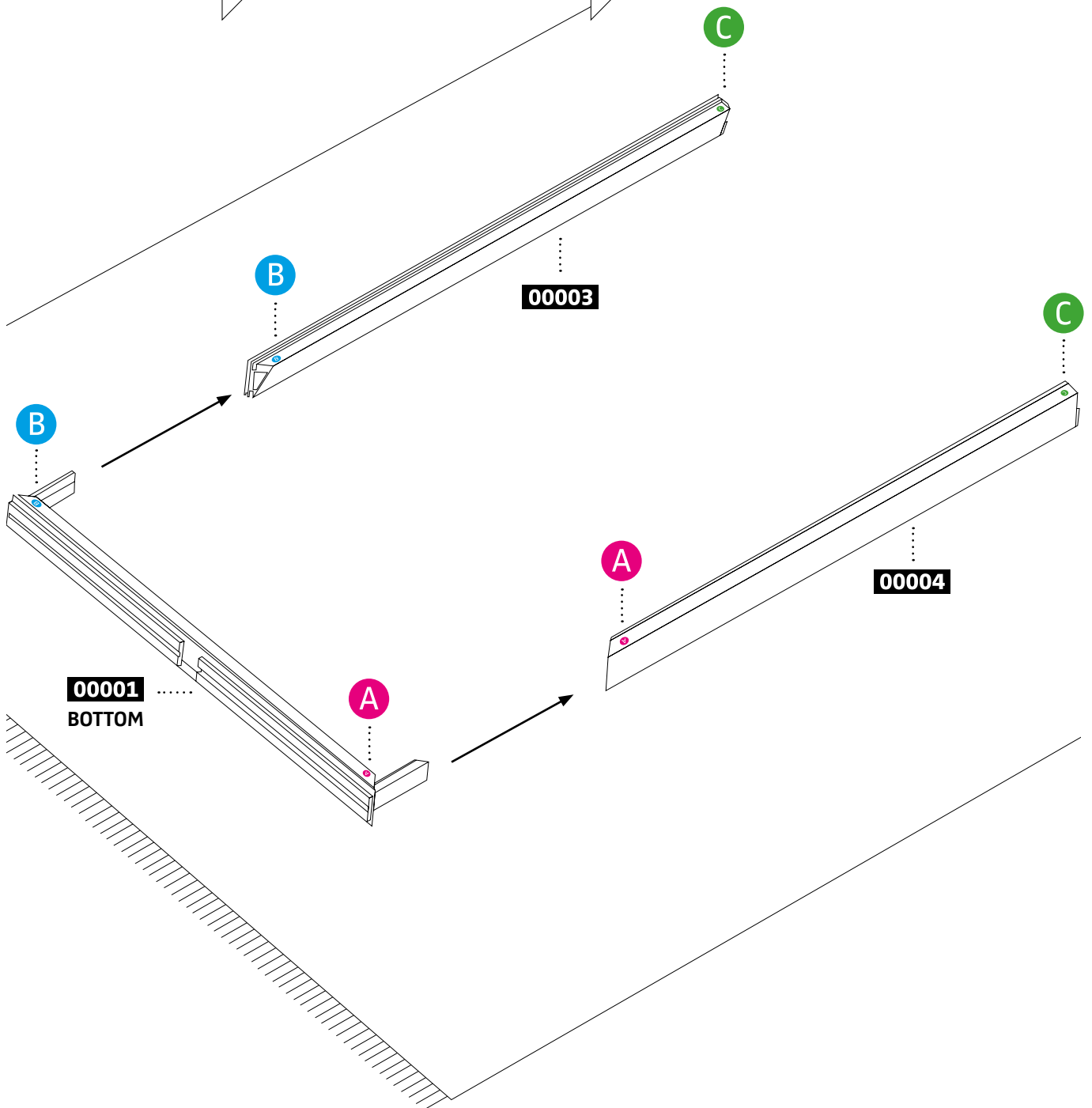

3

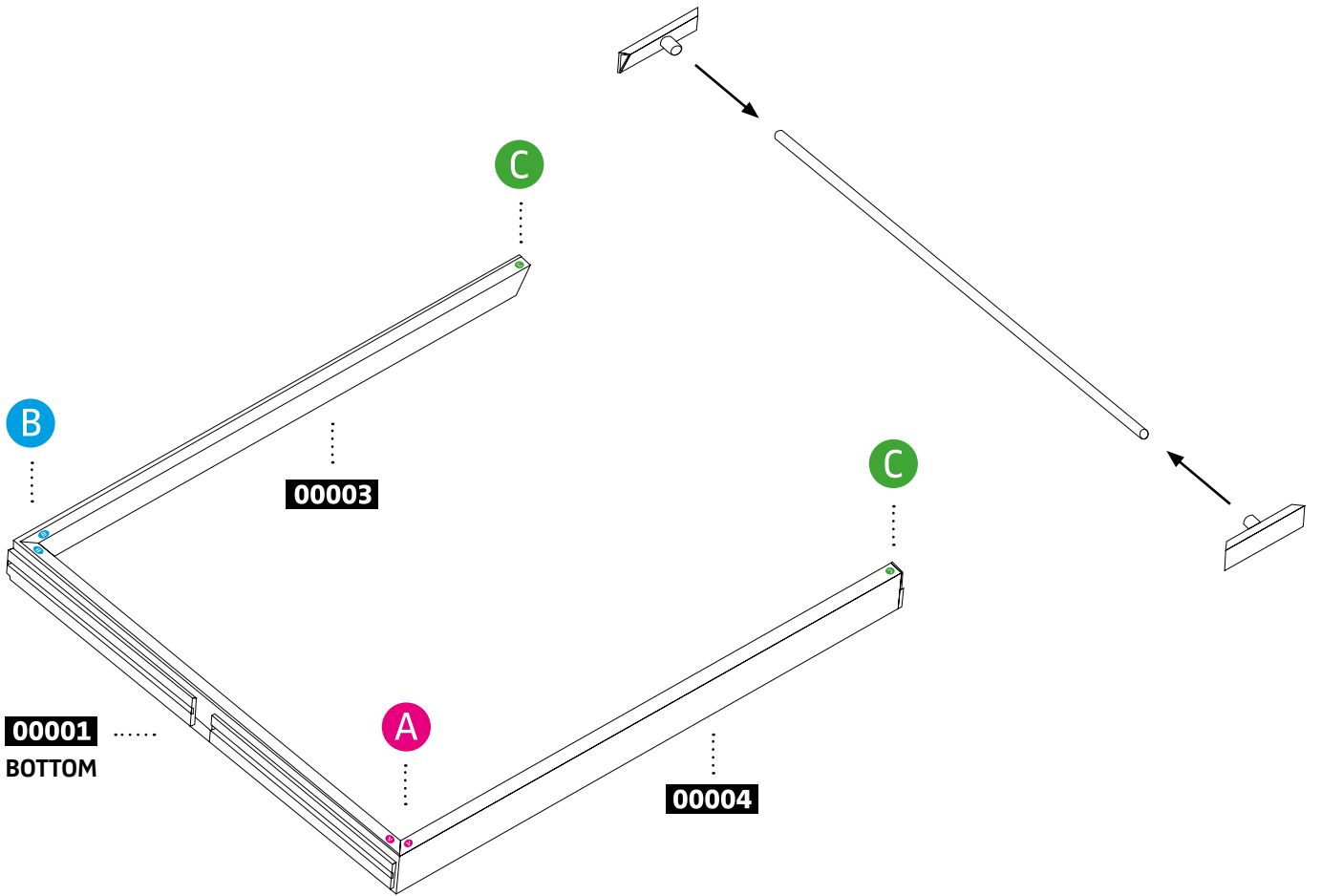

4

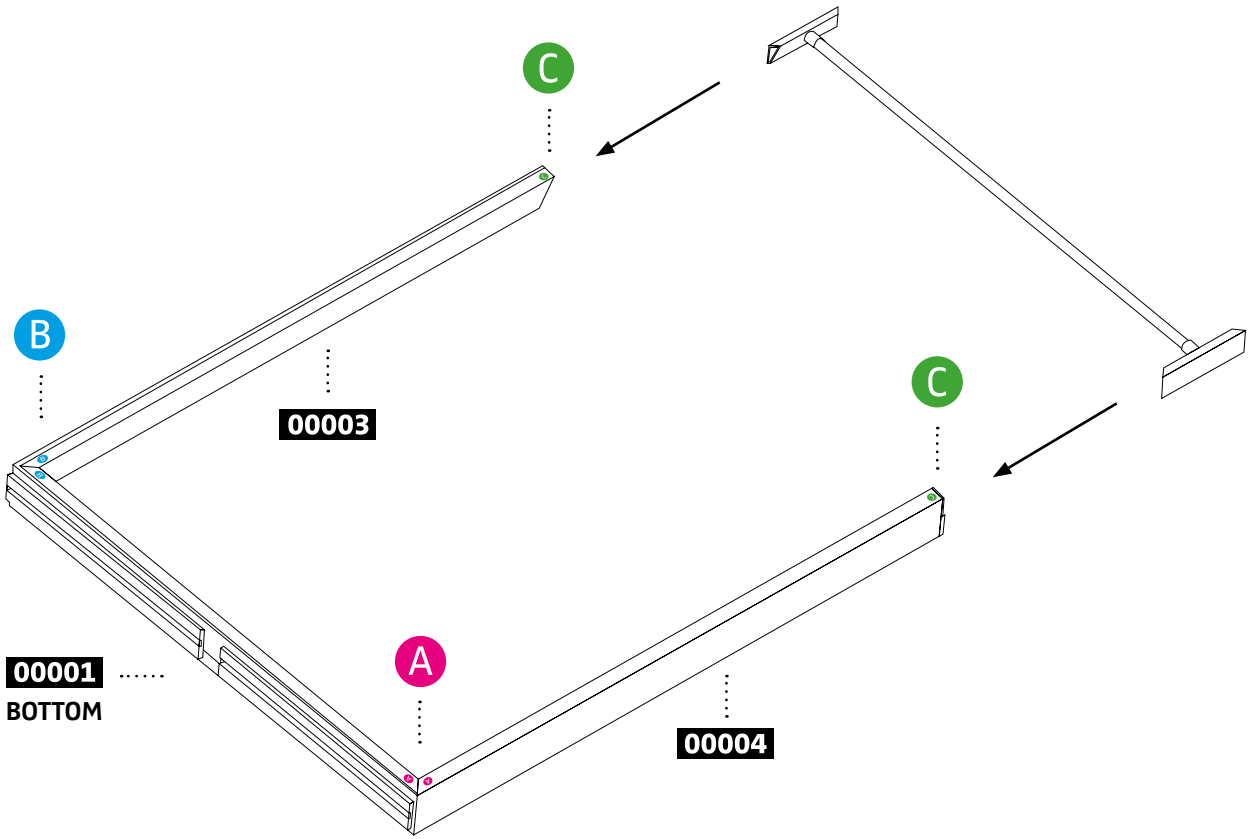

5

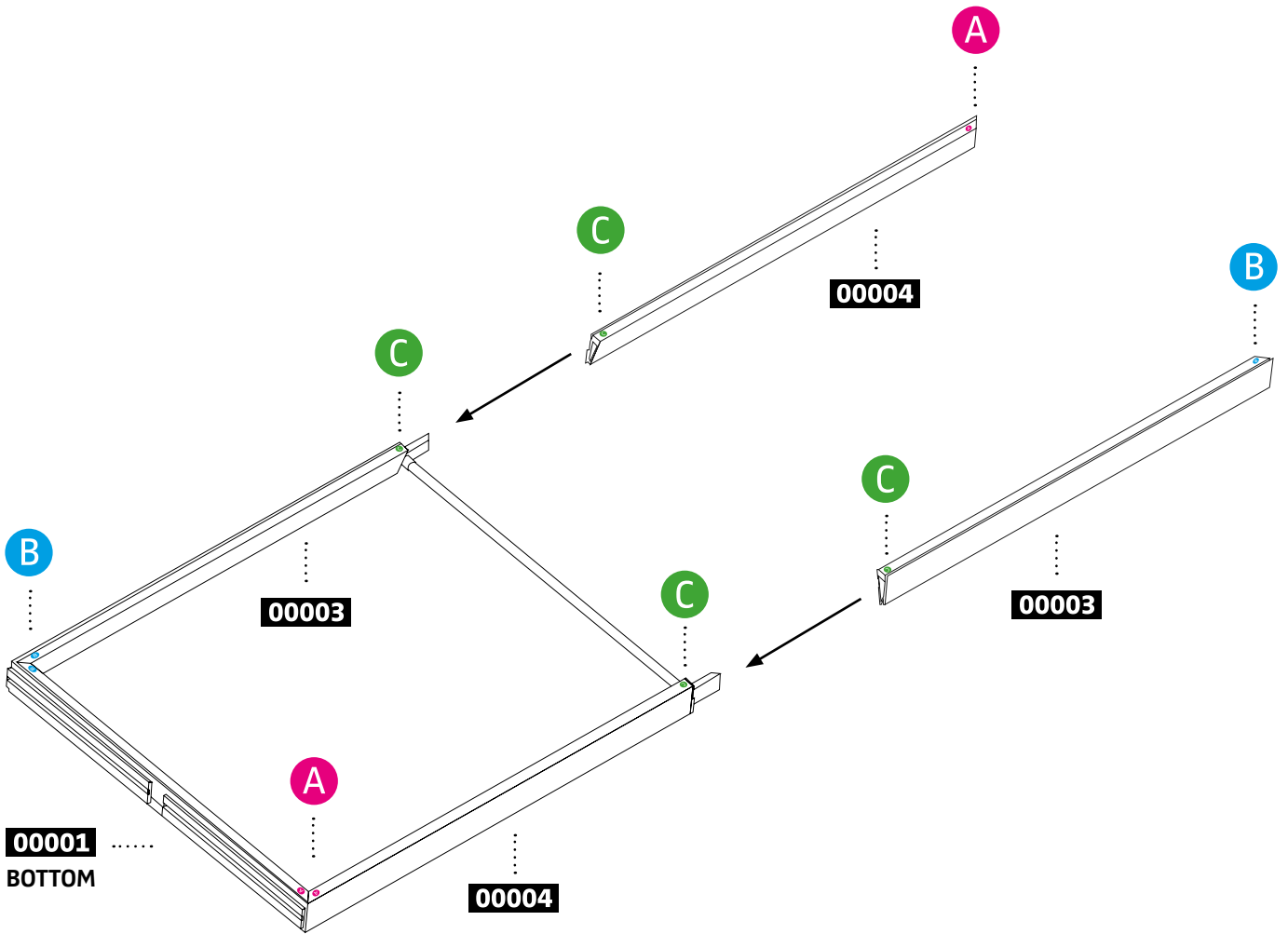

6

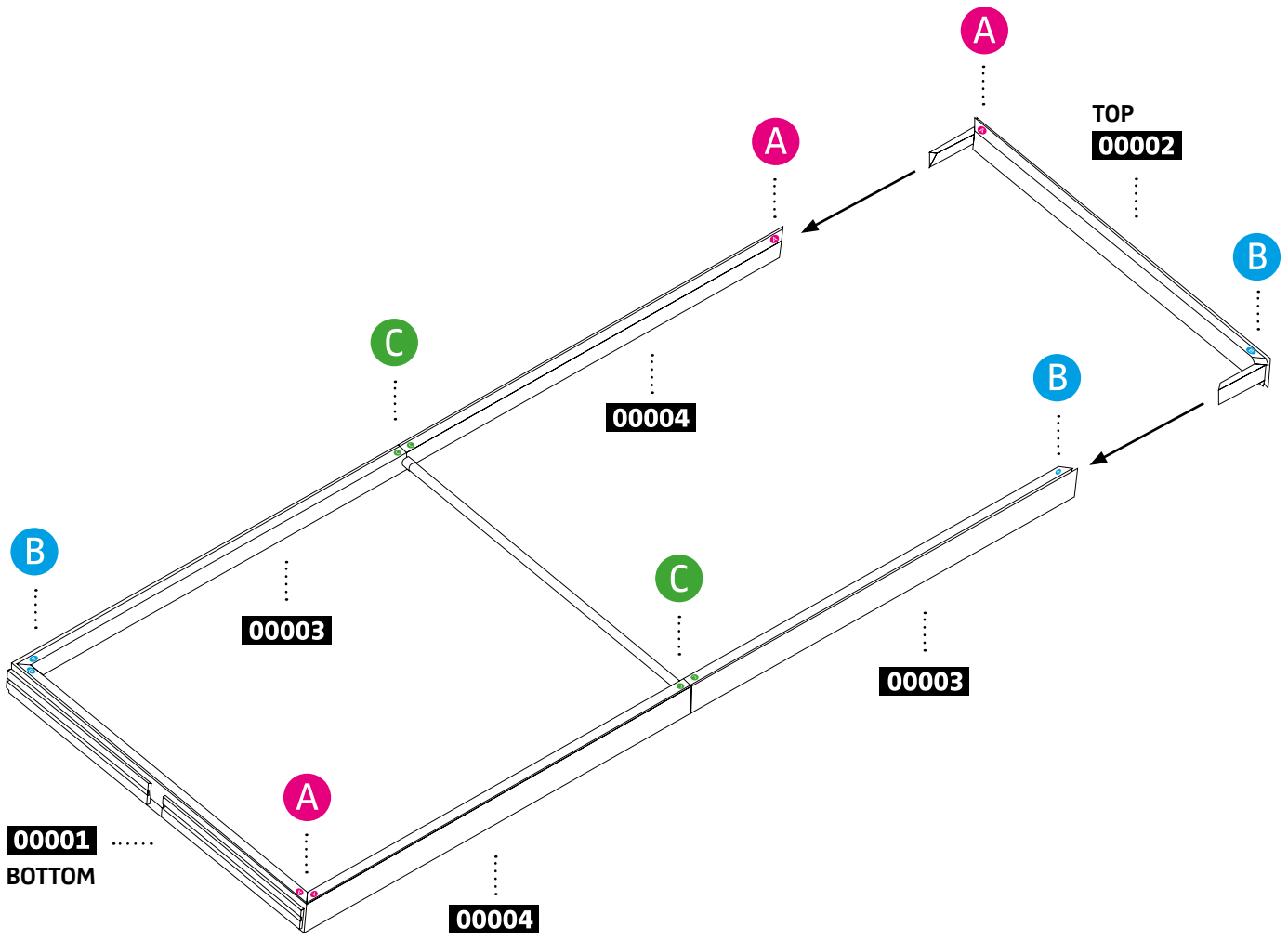

7

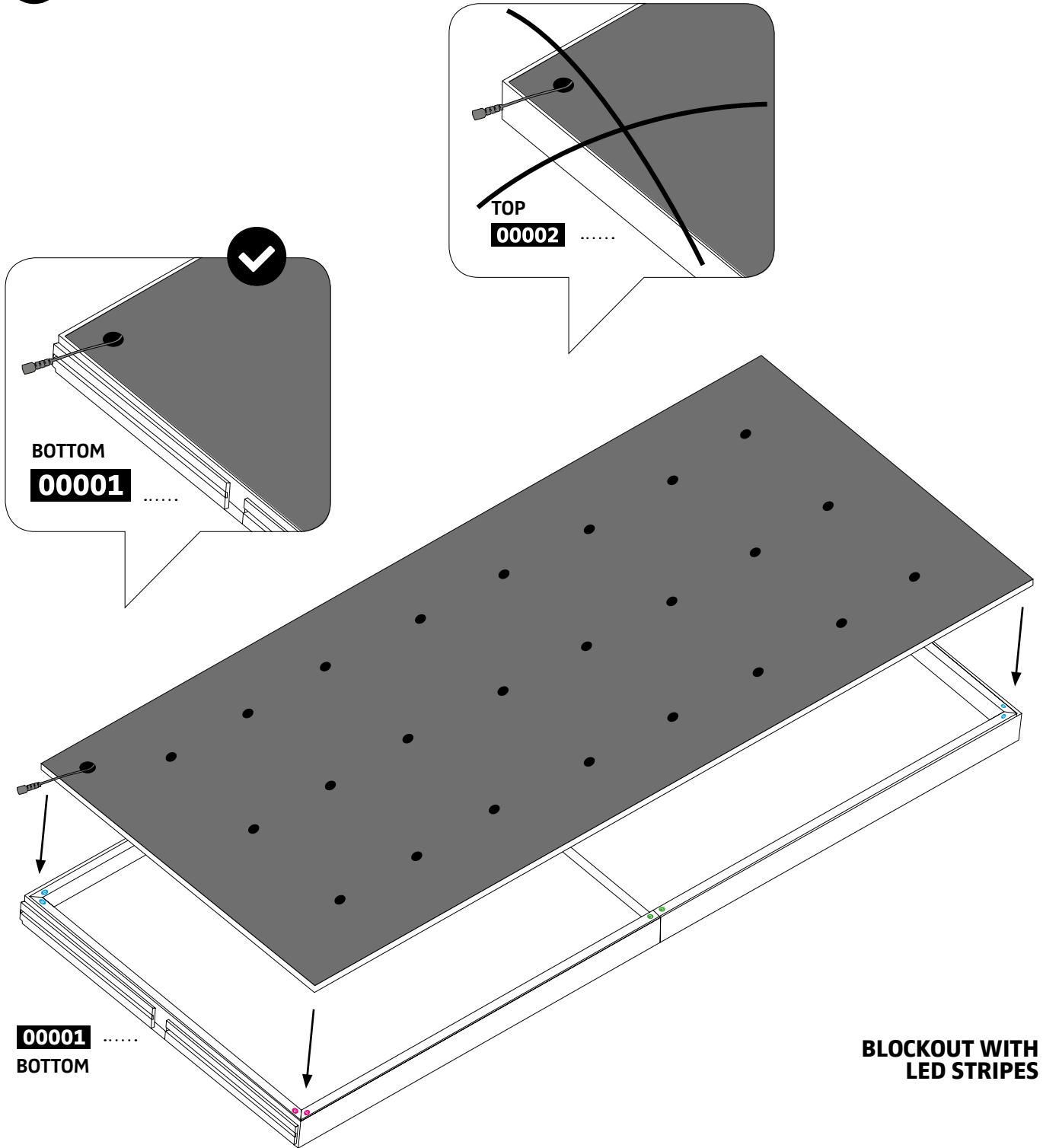

TIP!
The easiest way to insert the textile is to start with the corners.

8

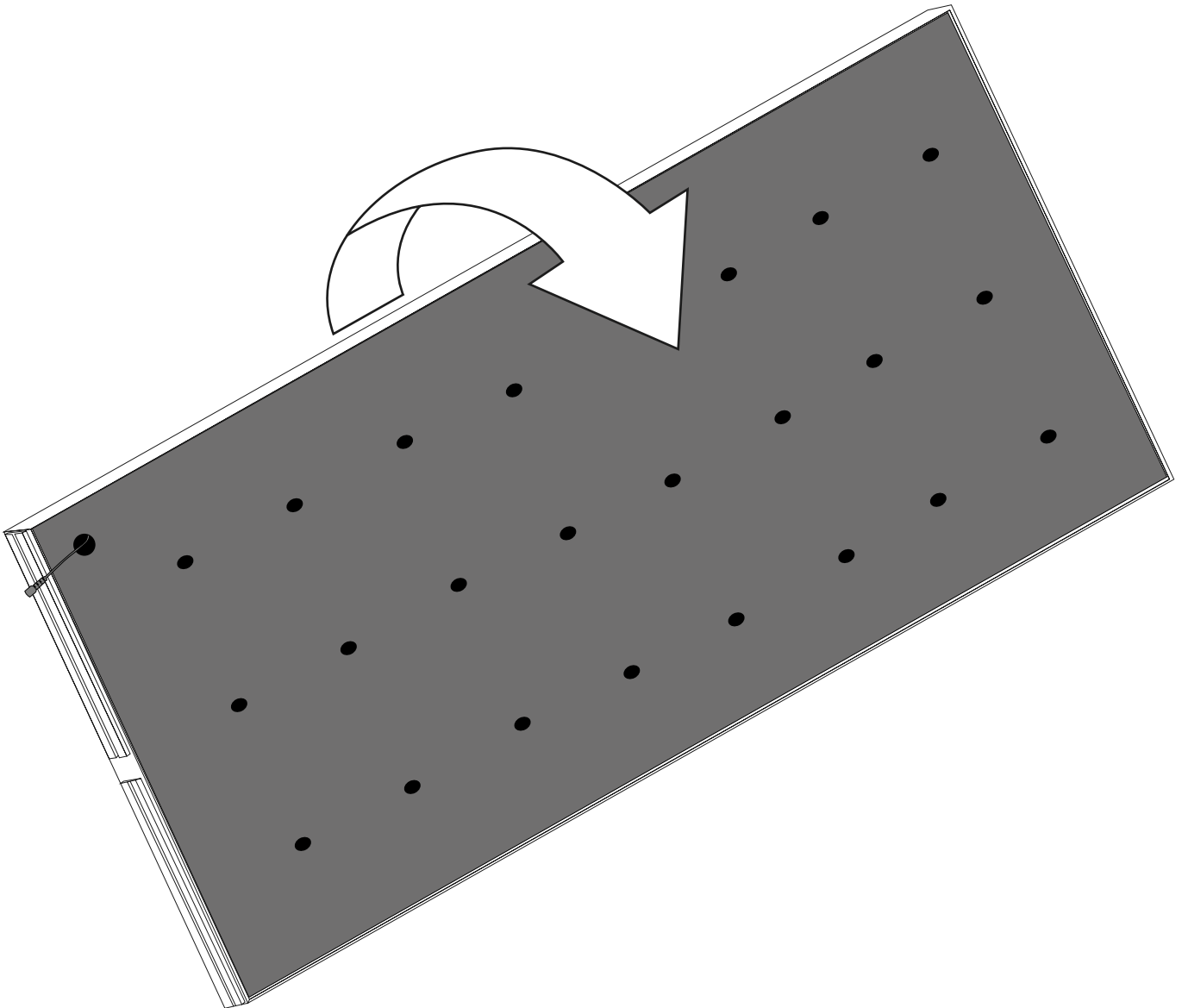

9



PRINT TEXTILE

10



00001
BOTTOM

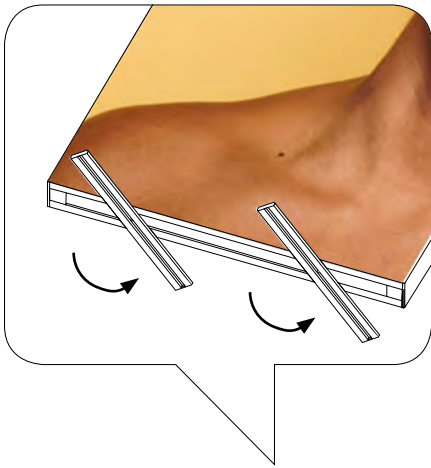

12

